

PRODUCT CODE:
BA05052



USER MANUAL

CONTENTS

| | |
|---|-----------|
| 1. INFORMATION | 1 |
| GENERAL NOTES | |
| INTENDED PURPOSE | |
| INDICATION | |
| CONTRAINDICATION | |
| 2. PRODUCT DESCRIPTION | 2 |
| SCOPE OF DELIVERY | |
| 3. ASSEMBLY INSTRUCTION | 3 |
| PRELIMINARY REMARKS | |
| ASSEMBLY | |
| 4. USING THE SHOWER AND TOILET CHAIR | 5 |
| BASIC SETTINGS | |
| USING THE TRANSIT LOCKING BRAKE | |
| USING THE SELF PROPELLED LOCKING BRAKE | |
| GETTING IN AND OUT FROM THE SIDE | |
| GETTING IN AND OUT FROM THE FRONT | |
| 5. USING THE SHOWER AND TOILET CHAIR | 8 |
| USING THE TOILET CHAIR | |
| AFTER USE | |
| USING WITH A CONVENTIONAL WC | |
| USING THE SHOWER CHAIR | |
| 6. TECHNICAL DATA | 9 |
| MAINTENANCE | |
| 7. INSTRUCTIONS FOR GENERAL USE | 10 |
| SAFETY INSTRUCTIONS | |
| CARE INSTRUCTIONS | |
| FORWARDING / REUSING | |
| DISPOSAL | |
| 8. GUARANTEE | 13 |
| WARRANTY | |
| DECLARATION OF CONFORMITY | |
| RESPONSIBILITY | |
| LIABILITY | |

1. INFORMATION

GENERAL NOTES

These instructions for use are part of the scope of delivery. They must be kept in a safe place by the user and remain with the product if re-sold. We reserve the right to alterations due to technical developments compared to the description provided in these instructions for use. Reproduction, translations and copies in any form, including extracts, require written approval from the manufacturer.

INTENDED PURPOSE

This shower and toilet chair is intended for use at home and in in-patient areas. It serves to increase independence in using the toilet or shower for persons with impaired physical functions. The shower and toilet chair is only for use inside and is designed for a maximum load of 120 kg.

INDICATION

Use of the Luxury Shower Chair Commode is appropriate if a disabled person cannot use the existing bath-tub and/ or shower or cannot use such with a bath or shower aid. Even if using or reaching the toilet is not possible due to disability, the Luxury Shower Chair Commode serves as a toilet chair and can also be used as a seat on account of the upholstered seating, back-rest and arm-rests.

CONTRAINDICATION

Use of the toilet wheelchair is not appropriate in the case of

- Perception disorders.
- Extreme imbalance
- Inability to sit
- With a body weight above 120 kg.



CAUTION Warnings about potential dangers with the risk of injury of the user or accompanying person.



ATTENTION Warning about potential dangers that might damage or destroy the product.



NOTE Valuable tips and tricks to help you use your wheelchair

2. PRODUCT DESCRIPTION

SCOPE OF DELIVERY

The scope of delivery includes:

- 1 shower and toilet chair incl. seat upholstery and hygiene cut-out, assembled by specialist trade
- Instructions for use with packaging and transport box (reusable)
- Foot plates and calf strap
- Self-propelled wheels
- Commode Pot

After unpacking, check the contents for completeness and full quantity pursuant to delivery documents.

Ramps, inclines and drops

- Do not drive onto steep ramps greater than the specified gradient. Refer to the section entitled "CLIMBING ANGLE" in "9. SPECIFICATION"
- Always use a low speed setting when ascending or descending a gradient.
- Do not drive on roads with large drops or potholes.
- Please slow down when driving on roads with inclines.
- Do not make sudden turns when driving on gravel roads or ramps.
- Always lean forward when climbing a steep gradient.



ATTENTION Check the packaging before unpacking. If the packaging is damaged, the contents may also be damaged. If damage to the contents can be identified, notify the carrier immediately. **Do not burn the foil!** Toxic gases may develop when burning

3. ASSEMBLY INSTRUCTION

Self-propelled Luxury Shower Commode



- | | |
|---------------------|----------------------|
| 1 - Push handle | 5 - Locking brake |
| 2 - Back cushion | 6 - Drive wheels |
| 3 - Arm-rest | 7 - Foot plate |
| 4 - Seat upholstery | 8 - Steering castors |

Transit Luxury Shower Commode



- | |
|---|
| 9 - Locking screw |
| 10 - Leg rest, swing away & removable |
| 11 - Steering castors with overall lock |
| 12 - Steering castors |

PRELIMINARY REMARKS

Thank you for choosing this technically perfect, reliable product of our company, designed in line with state of the art technology.

These instructions for use are intended for all users, especially care staff, as a basis for safe and hazard-free use of the shower and toilet chair. These instructions describe the preparation, operation, use, maintenance and care required for the product. To gain maximum use of this product and to maintain handling safety, please read the instructions for use, observe the respective instructions for use and ensure that the instructions are always accessible for the user.

ASSEMBLY

The shower and toilet chair must be assembled after unpacking. Assembly and functional check are executed by specialist trade. The respective technician from the specialist trade will adjust the shower and toilet chair to the respective user. The following instructions can help the trained user to assemble the Luxury Shower Commode Chair himself/ herself.



ATTENTION Please read the instructions for use before assembling and using the Luxury Shower Chair Commode.

3. ASSEMBLY INSTRUCTION

1. Mounting the back-rest

- First unscrew both locking screws on the frame.
- Push the tubes of the back-rest into the frame.
- Re-tighten the locking screws.
- Flap the arm-rests into position for use.



ATTENTION Please read the instructions for use before assembling and using the Luxury Shower Chair Commode.

2. Mounting the seat

- First actuate the locking brakes.
- Take the seating cushion and push it with the recess into the rear traverse bar of the frame.
- Now firmly press the seat onto the frame downwards.



3. Mounting the leg rest (Transit)

- Hook the leg supports in and swivel them forwards. The leg rest will then click into place automatically.



NOTE The rear castors are height adjustable to get the perfect fit. Use the 3 different holes to choose the correct height.



4. USING THE SHOWER AND TOILET CHAIR

BASIC SETTINGS

Height adjustment of the foot plate

- Unscrew the connection at the rear side of the leg rest tube.
- Set the correct height of the foot plate
- Re-tighten the screws.



ATTENTION Adjustment is correct if your thigh is vertical when placing your feet on the foot plate. (screw joint)

Adjusting the locking brake for the self-propelled Luxury Commode Shower Chair

- The brake must be screwed tightly and must not be loose.
- The distance between the mounting bolts and tire cover must be 35 mm at the narrowest position in case of max. opened brake mechanism!
- Untighten the fastening to adjust/correct the distance (1).
- Push the brakes into the correct position so that the distance mounting bolt-tire cover = 35 mm (2).
- Re-tighten the fastening and check the functionality. It should not be possible to move the shower and toilet chair when the brake is on.

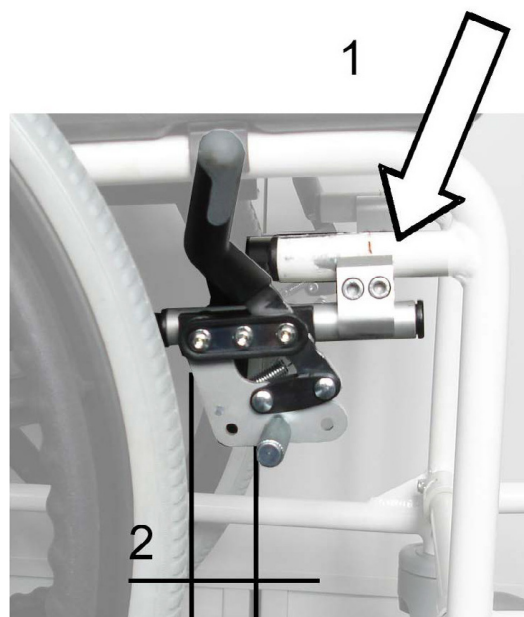

ATTENTION Check the setting of the brake regularly and re-adjust if necessary!



CAUTION Ensure equal settings on both sides of the toilet wheelchair.

4. USING THE SHOWER AND TOILET CHAIR

USING THE TRANSIT LOCKING BRAKE

The Transit Luxury Commode Shower Chair, is fitted with 5-inch swivel castors. The two rear castors are designed as overall locks. i.e. on actuation, the castors are locked against turning.

- Actuate the brake by treading down on the lock.
- To release the brake, lift up from underneath the lock.

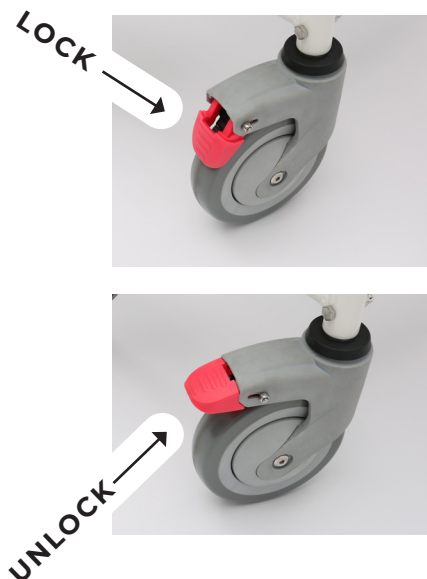

CAUTION If the locking brake is damaged or not usable, the toilet chair must not be used.

USING THE SELF PROPELLED LOCKING BRAKE

The Self-propelled Luxury Commode Shower Chair, is fitted with knee lever brakes which can be operated by the user. This is only to be used for parking. It is not suitable for braking when moving! This can be done by using the grip tires on which you can exert slight pressure with your hands.



4. USING THE SHOWER AND TOILET CHAIR

GETTING IN AND OUT FROM THE SIDE

- First, actuate the locking brakes.
- You can swivel the arm-rests backwards for easier getting in and out



CAUTION Danger of Jamming! When flapping down the arm-rests, clothing or parts of the body may get jammed in the bracket.

GETTING IN AND OUT FROM THE FRONT

- First, actuate the locking brakes.
- The foot plates can be swivelled outwards for easier getting in and out.



CAUTION Risk of Falling! Do not stand on the foot plate when getting up

5. USING THE SHOWER AND TOILET CHAIR

USING THE TOILET CHAIR

- First, actuate the locking brakes
- To use the toilet chair, place the bucket without lid under the seat.
- Push the bucket in from the rear until it locks.
- Remove the hygiene cut-out.

AFTER USE

- Bucket (pull out to the rear to empty)
- Place lid on
- After emptying, clean as described



USING WITH A CONVENTIONAL WC

- Pull the bucket out from the rear.
- Remove the hygiene cut-out.
- Flap open the lid of the WC.
- Move across the WC and actuate the locking brakes.

USING THE SHOWER CHAIR

- First, actuate the locking brakes.
- Remove the toilet bucket to use the shower chair.
- Pull the bucket out to the rear.
- Remove the hygiene cut-out for easier personal care and cleaning.



NOTE The toilet chair can be used with a conventional WC



ATTENTION Risk of injury from jamming! Do not pull out the bucket while the person is still sitting on the toilet chair

6. TECHNICAL DATA

| | Luxury Transit | Luxury Self-propelled |
|-----------------------------------|----------------|---------------------------------|
| Tires | 4 x wheels 5" | 2 x wheels 5" 2 x wheels 24" |
| Seat width (cm) | 46 | 46 |
| Seat depth (cm) | 40 | 40 |
| Seat height (cm) | 51 - 56 | 51-56 |
| Back height (cm) | 43 | 43 |
| Height of arm pad (cm) | 23 | 23 |
| Total width (cm) | 60 | 69 |
| Total length incl. leg rests (cm) | 88 | 101.5 |
| Total height (cm) | 96 - 101 | 96 - 101 |
| Cross-over height-WC (cm) | 43,5 | 43,5 |
| Weight (kg) | 12.75 | 18.25 |
| Max load (kg) | 120 | 120 |

MAINTENANCE

| Action | daily | monthly | annually | Remarks |
|----------------------------------|-------|---------|----------|------------------------------|
| Oil the wheel bearing | | | x | By specialist trade |
| Check brakes | x | | x | By user and specialist trade |
| Perfect condition of cushions | | x | x | By user and specialist trade |
| Perfect condition of frame parts | | x | x | By user and specialist trade |
| Perfect condition of connections | | x | x | By user and specialist trade |

7. INSTRUCTIONS FOR GENERAL USE

SAFETY INSTRUCTIONS

- Before using the shower and toilet chair please check that all parts connected have been properly tightened and that the brakes work.
- Secure your shower and toilet chair from rolling away.
- The shower and toilet chair must not be misused to transport several persons or loads. Please observe appropriate use.
- The shower and toilet chair must only be used inside and on solid, level ground.
- Please note that the risk of tipping can increase in the case of shifting of weight when moving your body.
- Please use ramps to cross any obstructions.
- Never stand on the foot plates when getting in and out.



NOTE The self-propelled version can be pushed by an attendant or alternatively from the patient it self.

7. INSTRUCTIONS FOR GENERAL USE

CARE INSTRUCTIONS

Clean the shower and toilet chair after every use. Disinfection should be made after every use as a toilet.

- The frame parts and upholstery can be wiped with damp cloth. You may use stronger cleaning agents in the case of stronger impurities.
- The wheels can be cleaned with a damp brush with plastic bristles (do not use wire brushes!).
- You may use conventional surface disinfection for disinfection purposes.



CAUTION Do not use a high-pressure or steam cleaner!

| Parts | Type of cleaning | Additives /Cleaning agents |
|--|---|----------------------------|
| Seat | Rinse under running water and disinfect | Conventional disinfectants |
| Bucket | Rinse and disinfect | Conventional disinfectants |
| Gestell | Wipe with damp cloth | Conventional disinfectants |
| Seat cushion, personal cut-out, arm-rest upholstery, back-rest cover | Wipe with damp cloth | Conventional disinfectants |

7. INSTRUCTIONS FOR GENERAL USE

FORWARDING / REUSING

In the event that the shower and toilet chair is forwarded / reused, please remember to hand over all technical documents required for safe handling to the new user. The shower and toilet chair must be cleaned and disinfected, and must be checked for damage and approved by the specialist retailer.

Alternative method for disinfection by washer: Remove all upholstery and fabrics prior to machine washing. The upholstery can be machine washed at max. 40°C (100°F). The advantage of steam washing is that it ensures a reliable and consistent hygiene standard.

Please use only the following disinfectants; use of other chemicals might damage the wheelchair.

- Aldehyde-free disinfectants based on alcohol (max. 70% propylalcohol)
- Oxygen-releasing disinfectants
- Aldehyde-based disinfectants



ATTENTION Please make sure to use any disinfectant or cleaner according to its intended purpose and read all instructions first.

DISPOSAL

If your the shower and toilet chair is no longer used and is to be disposed of, please contact a local disposal company to enquire about the regulations

8. GUARANTEE

WARRANTY

Warranty services refer to all product defects which are verifiably attributable to material or manufacturing flaws. The warranty period is 24 months as of receipt of notification of readiness for shipping, but following delivery at the latest. Damage which has occurred due to natural wear, intent, and negligent or improper operation or usage is excluded from the warranty obligation. This also applies to the use of unsuitable care products, lubricating oils or greases.

RESPONSIBILITY

CareCo can only take full responsibility for the safety, reliability and usability of the wheelchair if all modifications, adding of optional parts or repairs are carried out by authorised service personnel.

LIABILITY

CareCo only bears liability if the products are used under the specified conditions and for the specified purposes. We recommend that the products be handled appropriately and cared for according to the instructions. CareCo accepts no liability for damage caused by components and replacement parts which have not been approved by CareCo. Repairs must only be carried out by authorised specialist retailers or by the manufacturer itself.

NOTES

NOTES

